

Technical datasheet for:

**KmR**

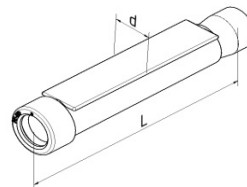

### General data

<b>Item</b>	Marking label with pipe plug - KmR KmR 7; KmR 10; KmR 12; KmR 14; KmR 16
<b>Description</b>	The marking label KmR is furnished with a pipe plug and is designed to brand speedpipe-ground with a permanent marker like Edding with the customer's address in the branch section. Additional protects a label cover the lettering against external influences. It is suitable for the gas- and water-tight sealing of initially unoccupied speedpipe ground up to 0,5 bar and can easily be installed.
<b>Package unit</b>	40 Pcs.

### Technical data

Quality	Value	Unit
<b>Material</b>	Acrylester-Styrol-Acrylnitril ASA	
<b>Dimension</b>	KmR 7:	d = 20; L = 122
	KmR 10:	d = 20; L = 122
	KmR 12:	d = 20; L = 122
	KmR 14:	d = 23; L = 122
	KmR 16:	d = 25; L = 122
<b>Pressure</b>	0,5	bar

**gabocom is certified by the quality system following DIN EN ISO 9001:2008**

gabo Systemtechnik GmbH  
Am Schaidweg 7  
94559 Niederwinkling  
Germany

Phone 0049 (0)9962 950 200  
Fax 0049 (0)9962 950 202  
info@gabocom.de  
www.gabocom.de

Editor: ZM  
Release: MK  
Edition: 15.03.2012

No responsibility is taken for the correctness, currency and completeness of details and information.  
Liability for damages is excluded.