

Technical datasheet for:

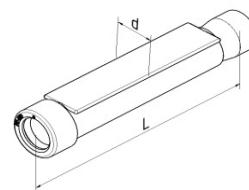

KmR

General data

Item	Marking label with pipe plug - KmR KmR 7; KmR 10; KmR 12; KmR 14; KmR 16
Description	The marking label KmR is furnished with a pipe plug and is designed to brand speedpipe-ground with a permanent marker like Edding with the customer's address in the branch section. Additional protects a label cover the lettering against external influences. It is suitable for the gas- and water-tight sealing of initially unoccupied speedpipe ground up to 0,5 bar and can easily be installed.
Package unit	40 Pcs.

Technical data

Quality	Value	Unit
Material	Acrylester-Styrol-Acrylnitril ASA	
Dimension	KmR 7: d = 20; L = 122	mm
	KmR 10: d = 20; L = 122	
	KmR 12: d = 20; L = 122	
	KmR 14: d = 23; L = 122	
	KmR 16: d = 25; L = 122	
Pressure	0,5	bar

gabocom is certified by the quality system following DIN EN ISO 9001:2008

gabo Systemtechnik GmbH
Am Schaidweg 7
94559 Niederwinkling
Germany

Phone 0049 (0)9962 950 200
Fax 0049 (0)9962 950 202
info@gabocom.de
www.gabocom.de

Editor: ZM
Release: MK
Edition: 15.03.2012

No responsibility is taken for the correctness, currency and completeness of details and information.
Liability for damages is excluded.